

PM63 Front View

502849
Housing
Assembly

1070
Housing Screws (8)

503598
Gauge Face Label

1757
Rocker Switch

504226
Gauge Assembly

9073
1/4" Bubble
Hose Nipple

1327
Knob

502586
Front Panel
Label

1328
Adjusting Knob
(Regulator)

1336
Knob Label

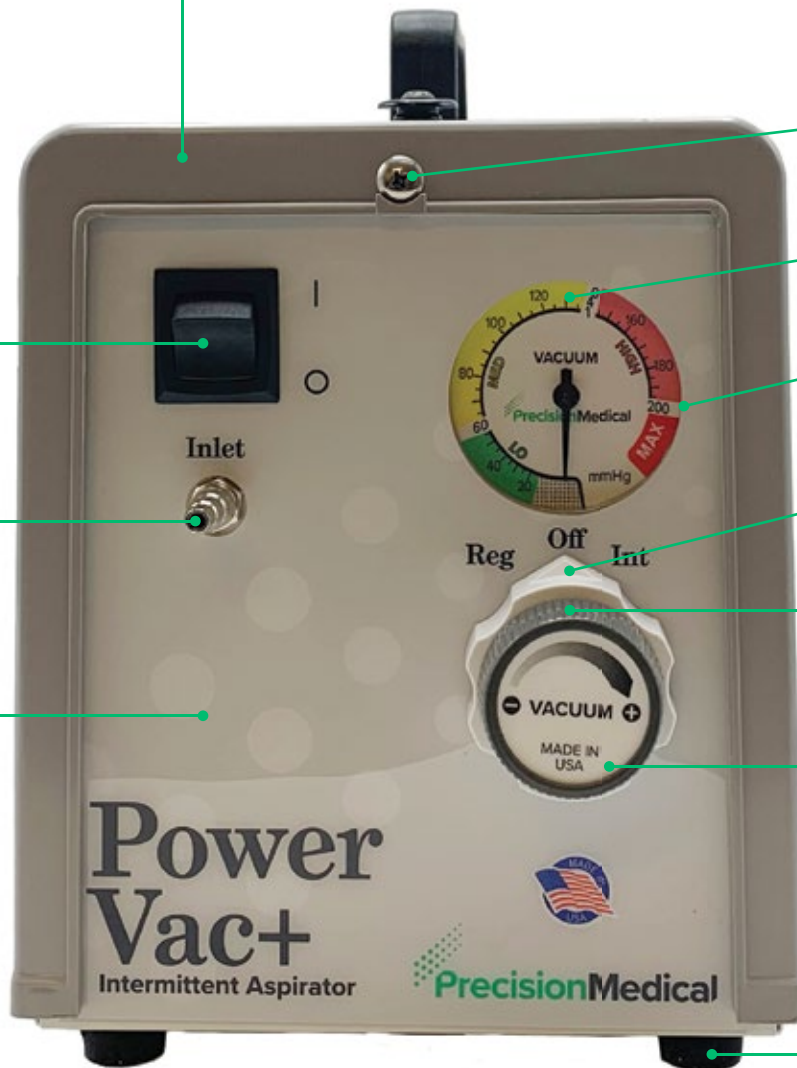

502396
Bumper Feet (4)

1265
Bumper Feet Screws (4)

PM63 Rear View



503237
Motor Filter

502594
Filter Label

502391
Muffler Filter

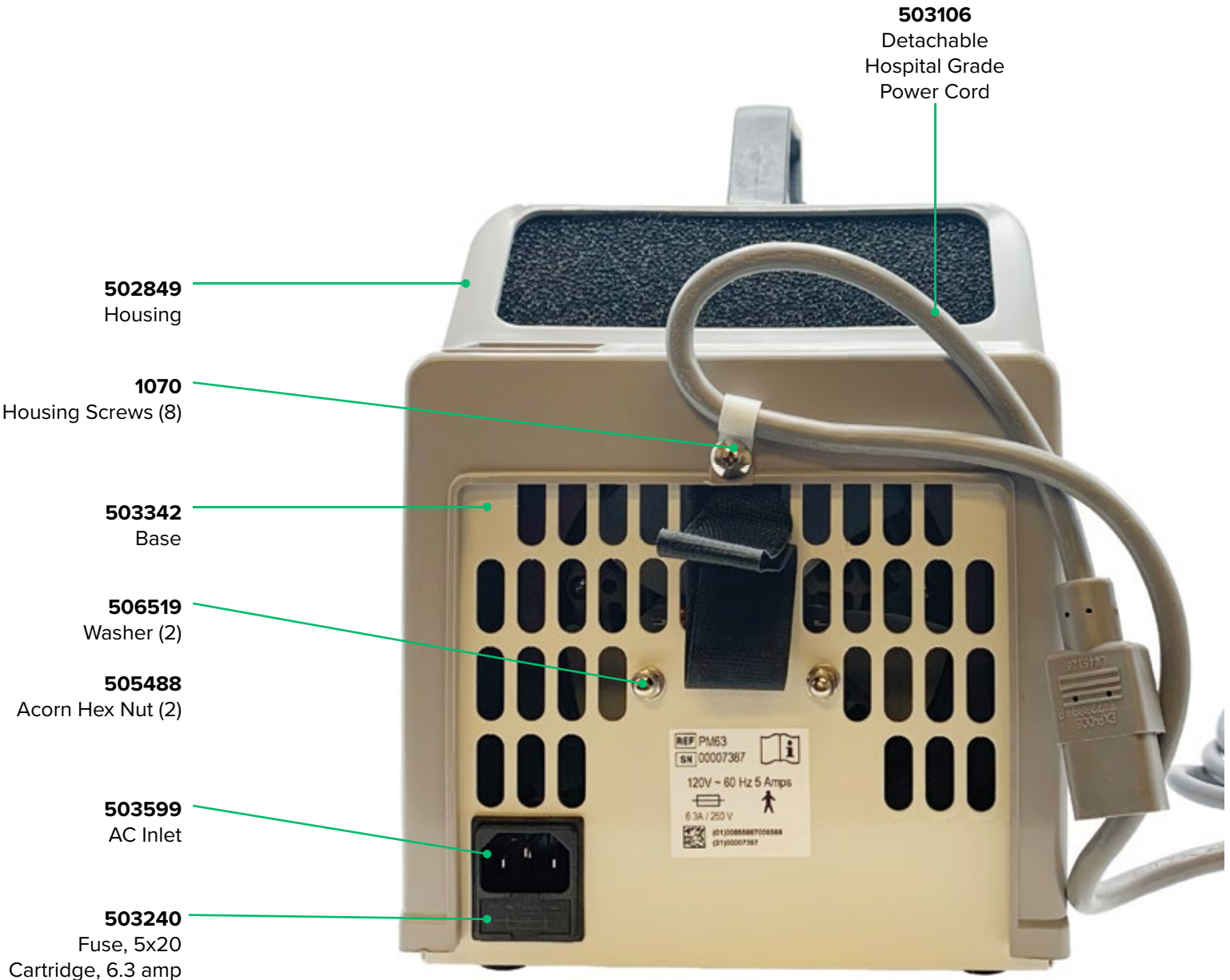

503106
Detachable
Hospital Grade
Power Cord

502849
Housing

1070
Housing Screws (8)

503342
Base

506519
Washer (2)

505488
Acorn Hex Nut (2)

503599
AC Inlet

503240
Fuse, 5x20
Cartridge, 6.3 amp

REF PM63
SN 00007387
120V ~ 60 Hz 5 Amps
6.3A / 250 V
01Y208686700886
01Y00007387

PM63 External Side View

502398
Handle

502540
Canister
Bracket



1070
Housing
Screws (8)

PM63 Internal Top View

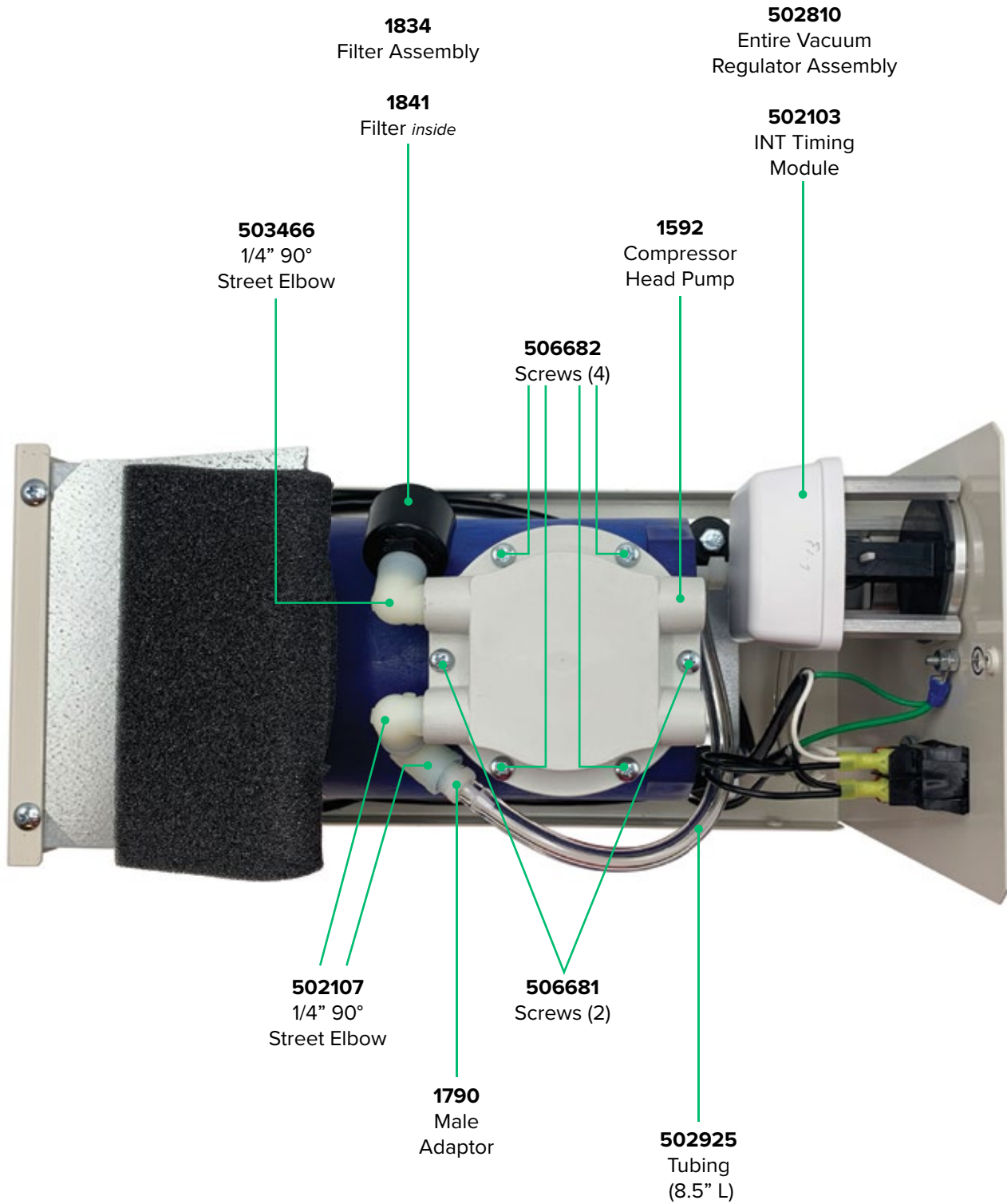

Item Not Shown

1792 - Spring Cable Wrap

PM63 Internal Left View

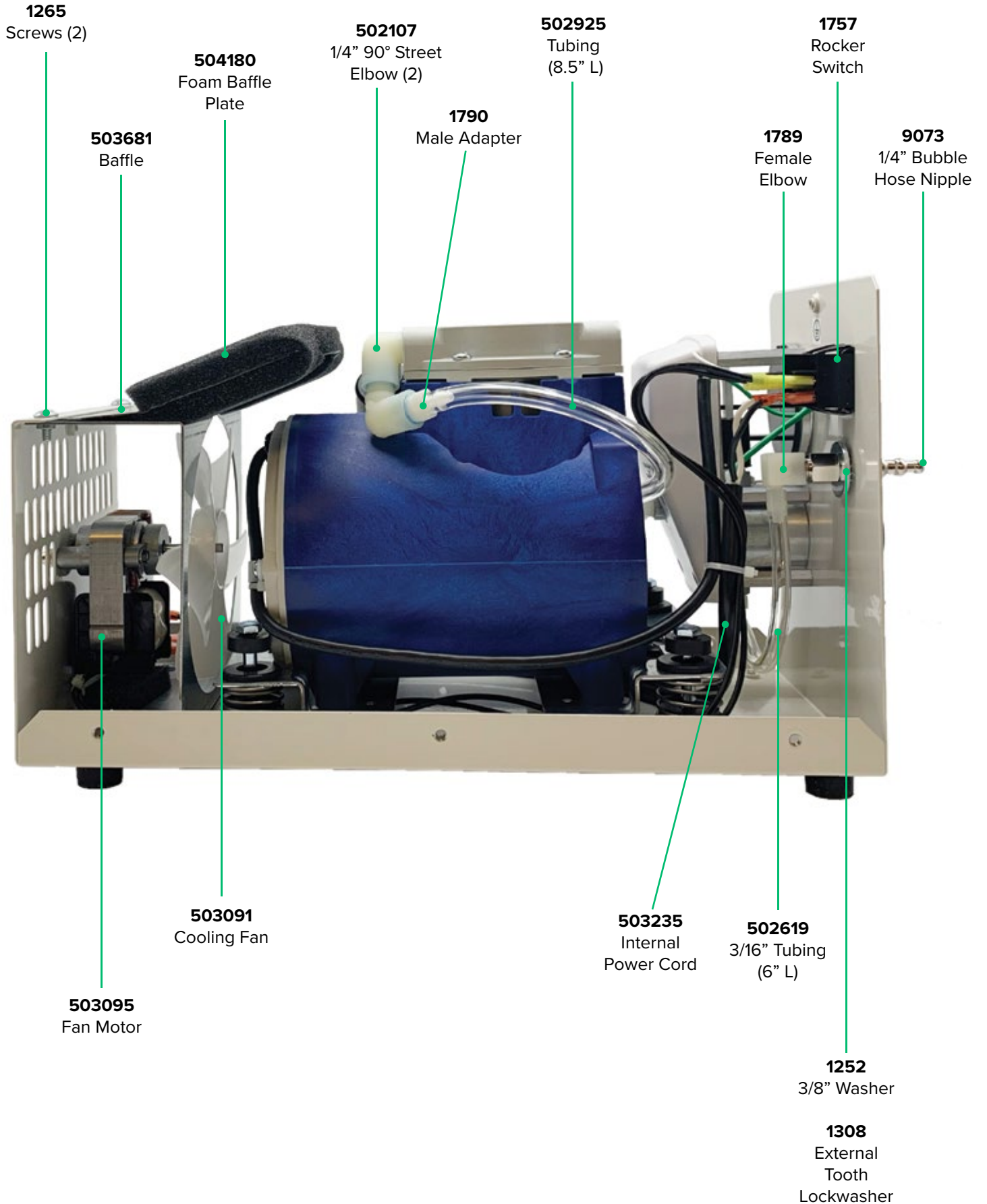

PM63 Internal Right View

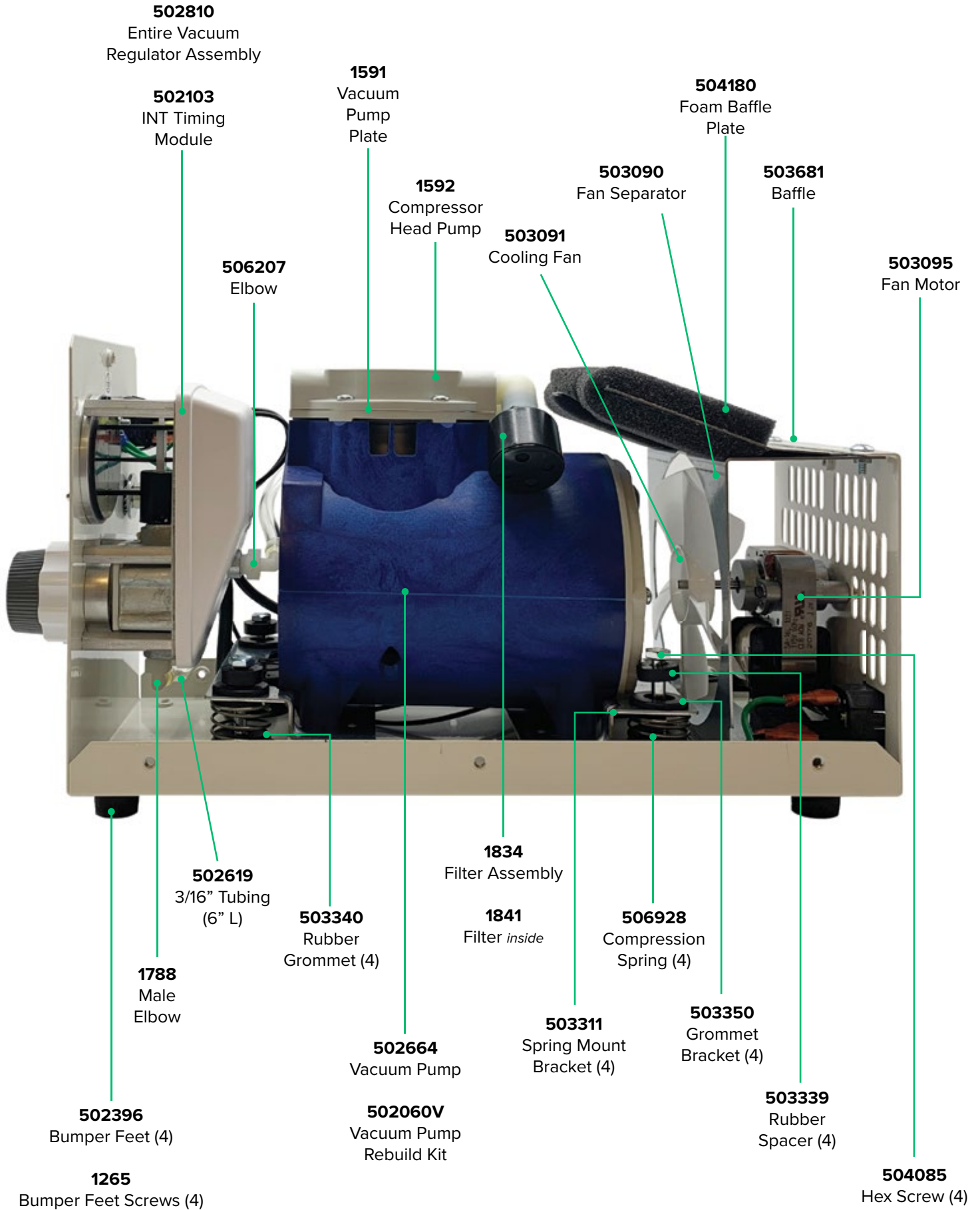

PM63 Intermittent Vacuum Regulator

